

- Metal slitting saws
- Metallkreissägeblätter
- Metaalzagen
- Fraises scies
- Sierras de ranurar o tronzar
- Serras Circulares p/ Abertura de Rasgos

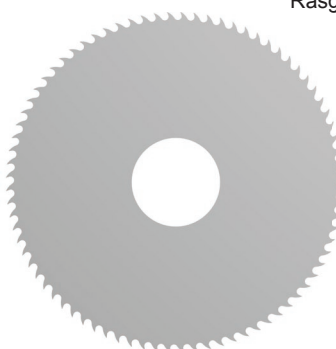

D747

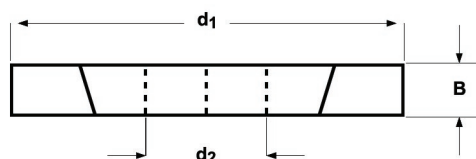

■ 1.1 1.2 1.3 2.1 3.1 3.2 3.3 4.1 4.2 5.1 5.2 6.1 6.2 6.3 7.1 7.2 7.3 8.1

d_1 Ø mm	B	d_2 Ø mm	z	e-Code	d_1 Ø mm	B	d_2 Ø mm	z	e-Code
32	0,3	8	80	D74732.0X.3	63	0,5	16	128	D74763.0X.5
32	0,4	8	80	D74732.0X.4	63	0,6	16	100	D74763.0X.6
32	0,5	8	80	D74732.0X.5	63	0,8	16	100	D74763.0X.8
32	0,6	8	64	D74732.0X.6	63	1,0	16	100	D74763.0X1.0
32	0,8	8	64	D74732.0X.8	63	1,2	16	80	D74763.0X1.2
32	1,0	8	64	D74732.0X1.0	63	1,5	16	80	D74763.0X1.5
32	1,2	8	48	D74732.0X1.2	63	1,6	16	80	D74763.0X1.6
32	1,5	8	48	D74732.0X1.5	63	2,0	16	80	D74763.0X2.0
32	1,6	8	48	D74732.0X1.6	63	2,5	16	64	D74763.0X2.5
32	2,0	8	48	D74732.0X2.0	63	3,0	16	64	D74763.0X3.0
32	2,5	8	40	D74732.0X2.5	63	4,0	16	64	D74763.0X4.0
32	3,0	8	40	D74732.0X3.0	63	5,0	16	48	D74763.0X5.0
40	0,3	10	100	D74740.0X.3	63	6,0	16	48	D74763.0X6.0
40	0,4	10	100	D74740.0X.4	80	0,4	22	160	D74780.0X.4
40	0,5	10	80	D74740.0X.5	80	0,5	22	128	D74780.0X.5
40	0,6	10	80	D74740.0X.6	80	0,6	22	128	D74780.0X.6
40	0,8	10	80	D74740.0X.8	80	0,8	22	128	D74780.0X.8
40	1,0	10	64	D74740.0X1.0	80	1,0	22	100	D74780.0X1.0
40	1,2	10	64	D74740.0X1.2	80	1,2	22	100	D74780.0X1.2
40	1,5	10	64	D74740.0X1.5	80	1,5	22	100	D74780.0X1.5
40	1,6	10	64	D74740.0X1.6	80	1,6	22	100	D74780.0X1.6
40	2,0	10	48	D74740.0X2.0	80	2,0	22	80	D74780.0X2.0
40	2,5	10	48	D74740.0X2.5	80	2,5	22	80	D74780.0X2.5
40	3,0	10	48	D74740.0X3.0	80	3,0	22	80	D74780.0X3.0
50	0,3	13	128	D74750.0X.3	80	4,0	22	64	D74780.0X4.0
50	0,4	13	100	D74750.0X.4	80	5,0	22	64	D74780.0X5.0
50	0,5	13	100	D74750.0X.5	80	6,0	22	64	D74780.0X6.0
50	0,6	13	100	D74750.0X.6	100	0,5	22	160	D747100.0X.5
50	0,8	13	80	D74750.0X.8	100	0,6	22	160	D747100.0X.6
50	1,0	13	80	D74750.0X1.0	100	0,8	22	128	D747100.0X.8
50	1,2	13	80	D74750.0X1.2	100	1,0	22	128	D747100.0X1.0
50	1,5	13	64	D74750.0X1.5	100	1,2	22	128	D747100.0X1.2
50	1,6	13	64	D74750.0X1.6	100	1,5	22	100	D747100.0X1.5
50	2,0	13	64	D74750.0X2.0	100	1,6	22	100	D747100.0X1.6
50	2,5	13	64	D74750.0X2.5	100	2,0	22	100	D747100.0X2.0
50	3,0	13	48	D74750.0X3.0	100	2,5	22	100	D747100.0X2.5
50	4,0	13	48	D74750.0X4.0	100	3,0	22	80	D747100.0X3.0
50	5,0	13	48	D74750.0X5.0	100	4,0	22	80	D747100.0X4.0
50	6,0	13	40	D74750.0X6.0	100	5,0	22	80	D747100.0X5.0
63	0,3	16	128	D74763.0X.3	100	6,0	22	64	D747100.0X6.0
63	0,4	16	128	D74763.0X.4	125	1,0	22	160	D747125.0X1.0

D747

DORMER

d ₁ Ø mm	B	d ₂ Ø mm	z	e-Code	d ₁ Ø mm	B	d ₂ Ø mm	z	e-Code
125	1,2	22	128	D747125.0X1.2	200	1,2	32	200	D747200.0X1.2
125	1,5	22	128	D747125.0X1.5	200	1,5	32	160	D747200.0X1.5
125	1,6	22	128	D747125.0X1.6	200	1,6	32	160	D747200.0X1.6
125	2,0	22	128	D747125.0X2.0	200	2,0	32	160	D747200.0X2.0
125	2,5	22	100	D747125.0X2.5	200	2,5	32	160	D747200.0X2.5
125	3,0	22	100	D747125.0X3.0	200	3,0	32	128	D747200.0X3.0
125	4,0	22	100	D747125.0X4.0	200	4,0	32	128	D747200.0X4.0
125	5,0	22	80	D747125.0X5.0	200	5,0	32	128	D747200.0X5.0
125	6,0	22	80	D747125.0X6.0	200	6,0	32	100	D747200.0X6.0
160	1,0	32	160	D747160.0X1.0	250	2,0	32	200	D747250.0X2.0
160	1,2	32	160	D747160.0X1.2	250	2,5	32	160	D747250.0X2.5
160	1,5	32	160	D747160.0X1.5	250	3,0	32	160	D747250.0X3.0
160	1,6	32	160	D747160.0X1.6	250	4,0	32	160	D747250.0X4.0
160	2,0	32	128	D747160.0X2.0	250	5,0	32	128	D747250.0X5.0
160	2,5	32	128	D747160.0X2.5	250	6,0	32	128	D747250.0X6.0
160	3,0	32	128	D747160.0X3.0	315	2,5	40	200	D747315.0X2.5
160	4,0	32	100	D747160.0X4.0	315	3,0	40	200	D747315.0X3.0
160	5,0	32	100	D747160.0X5.0	315	4,0	40	160	D747315.0X4.0
160	6,0	32	100	D747160.0X6.0	315	5,0	40	160	D747315.0X5.0
200	1,0	32	200	D747200.0X1.0	315	6,0	40	160	D747315.0X6.0